





* Introduction

High speed bevel gear screw jacks offers higher efficiency and greater speed than other series mechanical worm gear screw jacks. At the same time, high speed bevel gear jack still provide the benefit of a self-locking trapezoidal screw, no special brake is required to prevent the jack from lowering under load. Spiral bevel gears increase strength for higher capacities.

High speed bevel gear screw jacks also act as a miter gear box, making them an ideal choice for multi-jack lifting systems. As many as three output shafts may be specified for mounting motors, limit switches, readout devices and other accessories.

High speed bevel gear screw jacks come in translating screw and rotating screw (keyed for traveling nut) designs. Jacks are available with one of four standard screw ends or special ends to meet your requirements.

Features:

- * Model: RNS15, RNS25, RNS50, RNS90
- * Load Capacities From 15KN to 90KN As Standard
- * Gear Ratios 2:1, 3:1
- * Max Lifting Speed 9000mm/min
- * Self Locking Trapezoidal Screw, Spiral Bevel Gears, Max Stroke 6000 mm
- * Upright and Inverted mounting
- * Top End: Top Plate, Clevis End, Threaded End, Plain End and Forked Head
- * Lifting, Lowering, Pushing, Pulling and Rolling Linear Motions
- * Single Unit, In Pairs or Multi-Units Arrangement Available
- * Electric Driven, Manual Operated or Both Are Available
- * Casting Iron and Die-Casting Aluminum Housing
- * Special Custom Design Available
- * Accessories: Protective Tube, Rubber Bellows, Electric Motor, Hand Wheel, Inverter, Limited Switches, Linking Shaft, Coupling, Pillow Block Bearing, Counter, Bevel Gearbox, Swivel Plate and Trunnion Base

Materials:

- * Lifting Screw: steel C45 (optional: stainless steel)
- * Worm Gear: bronze
- * Worm Shaft: heated treated steel C45 (optional: stainless steel)
- * Bearing: taper roll bearing
- * Housing: casting iron (optional: aluminum for small model)
- * Oil Sealing (optional: high/low temperature oil sealing)
- * Spiral bevel gears: alloy steel, case hardened, be of high rigidity and wear resistance

* Selection Guide

1. Model Selection

Model	RNS15	RNS25	RNS50	RNS90
Lifting Capacity(tons)	1.5	2.5	5	9
Lifting Screw(Tr) mm	24x5	35x8	40x7	60x9
Gear Ratio(N)	2:1	2:1	2:1	2:1
Gear Ratio(L)	3:1	3:1	3:1	3:1
Travel/Turn(N) mm	2.5	4	3.5	4.5
Travel/Turn(L) mm	1.67	2.67	2.33	3
Worm Torque at Full Load(N) Nm	16	40	80	207
Worm Torque at Full Load(L) Nm	12	28	54	140
Efficiency Rating(N) %	37	38	33	30
Efficiency Rating(L) %	33	38	33	30
Max Power/Jack kw	1.3	2.6	3.8	13
Max Input Shaft Torque Nm	50	125	175	1,600
Housing Weight kg	9	13.5	23	85
Screw&Pipe Weight/100mm Stroke kg	0.8	0.59	1.5	2.5

2. Installation Selection

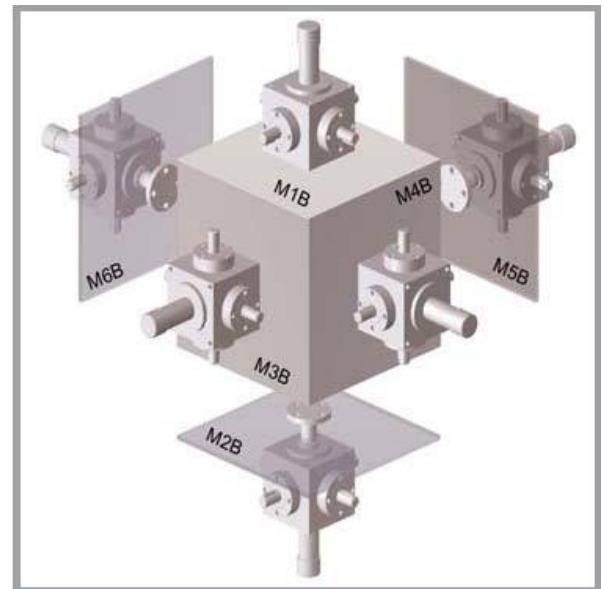
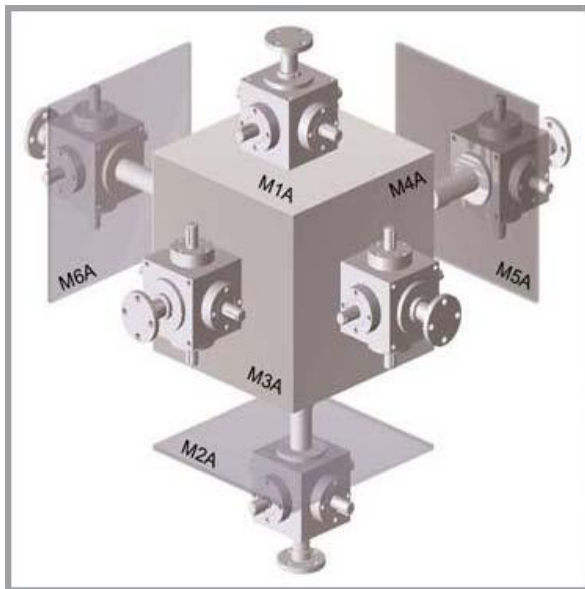



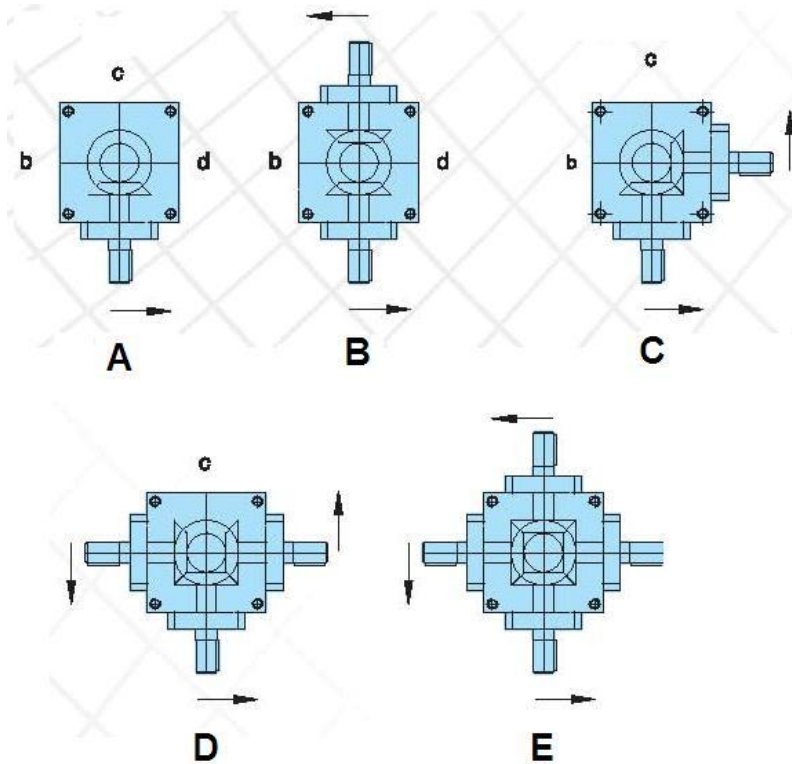

* Selection Guide

3. Input Forms Selection



4. Screw Top End Types Selection

			
<p>T (top plate)</p>	<p>H (clevis end)</p>	<p>S (threaded end)</p>	<p>R (plain end)</p>

5. Gear Ratio Selection

Manual Operated

N: Fast speed: 1 full turn 1 mm travel

L: Low speed: 1 full turn 0.25 mm travel

Electric Driven (input 1500 rpm)

N: Fast speed: 1500 mm/min

L: Low speed: 375 mm/min

6. Travel Stroke (mm)

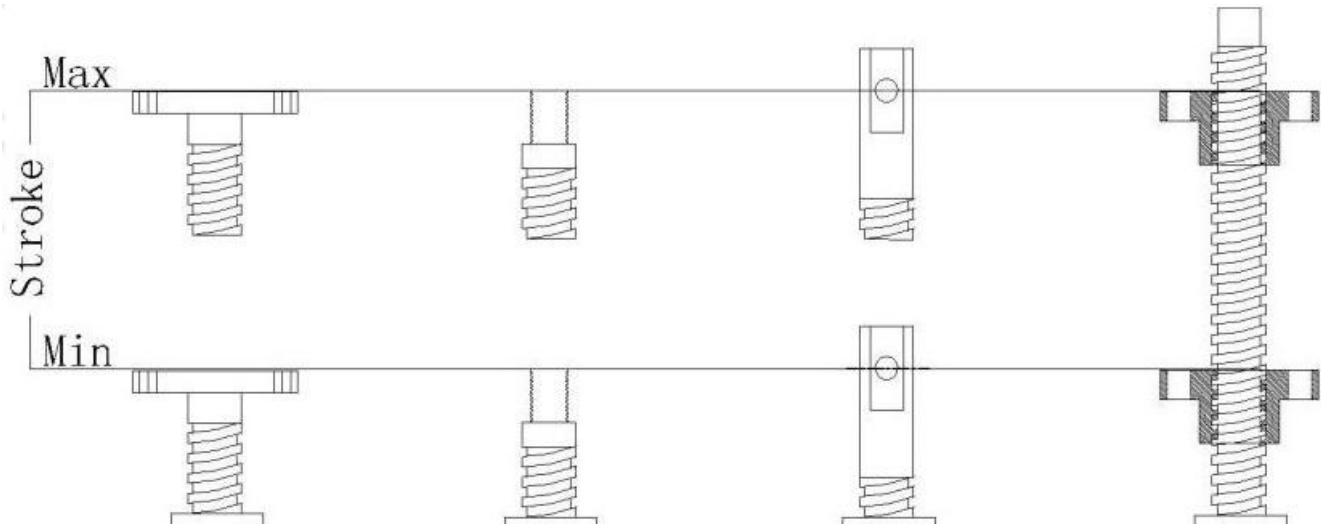

7. Duty & Environment Selection

Duty Cycles _____ times per day or _____ times per month

Ambient Temperature _____ °C

Conditions _____ (Clean / Dirty, Indoor / Outdoor)

8. Accessories Selection

N=Standard jack, no additional options

P=Protective tube

R=Rubber bellows

Y=Hand wheel

9. Design application sketch, very important

10. Special working conditions, please consult sales / engineers

* Screw Jack System

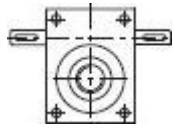

Screw Jack

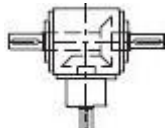

Bevel Gearbox

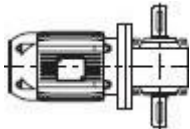

Motor+ Worm Reducer

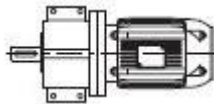

Gear Motor

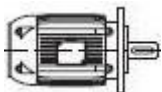

Vertical Motor

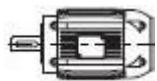

Foot Mount Motor

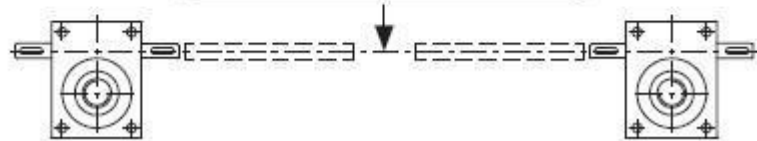
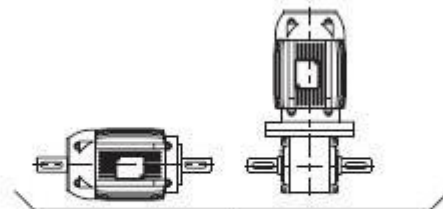
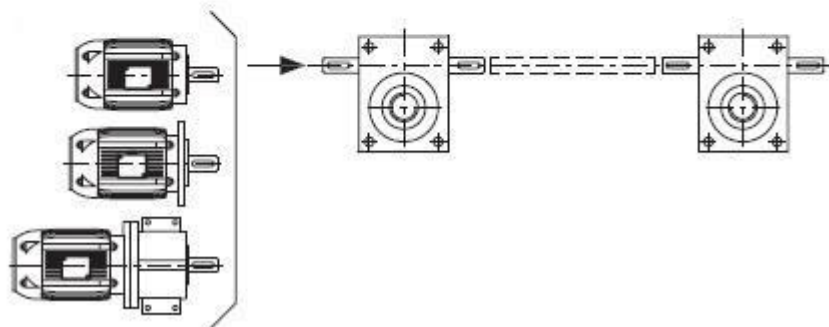
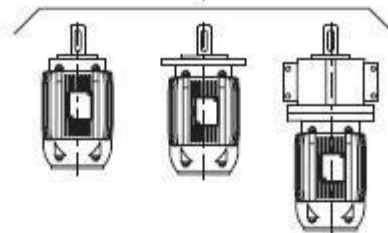
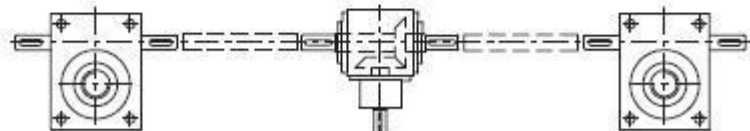
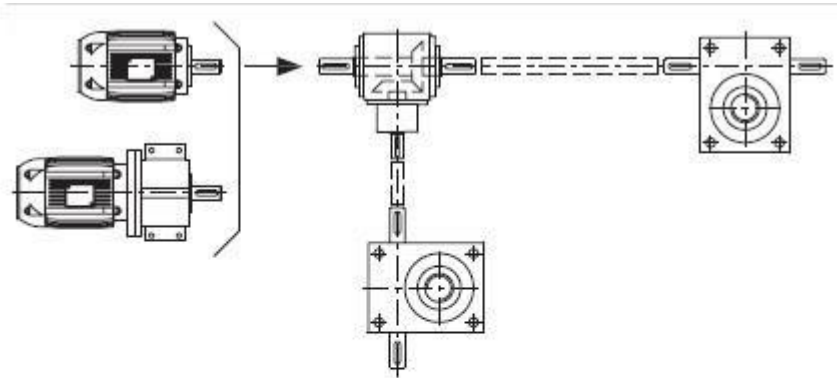

* Screw Jack System

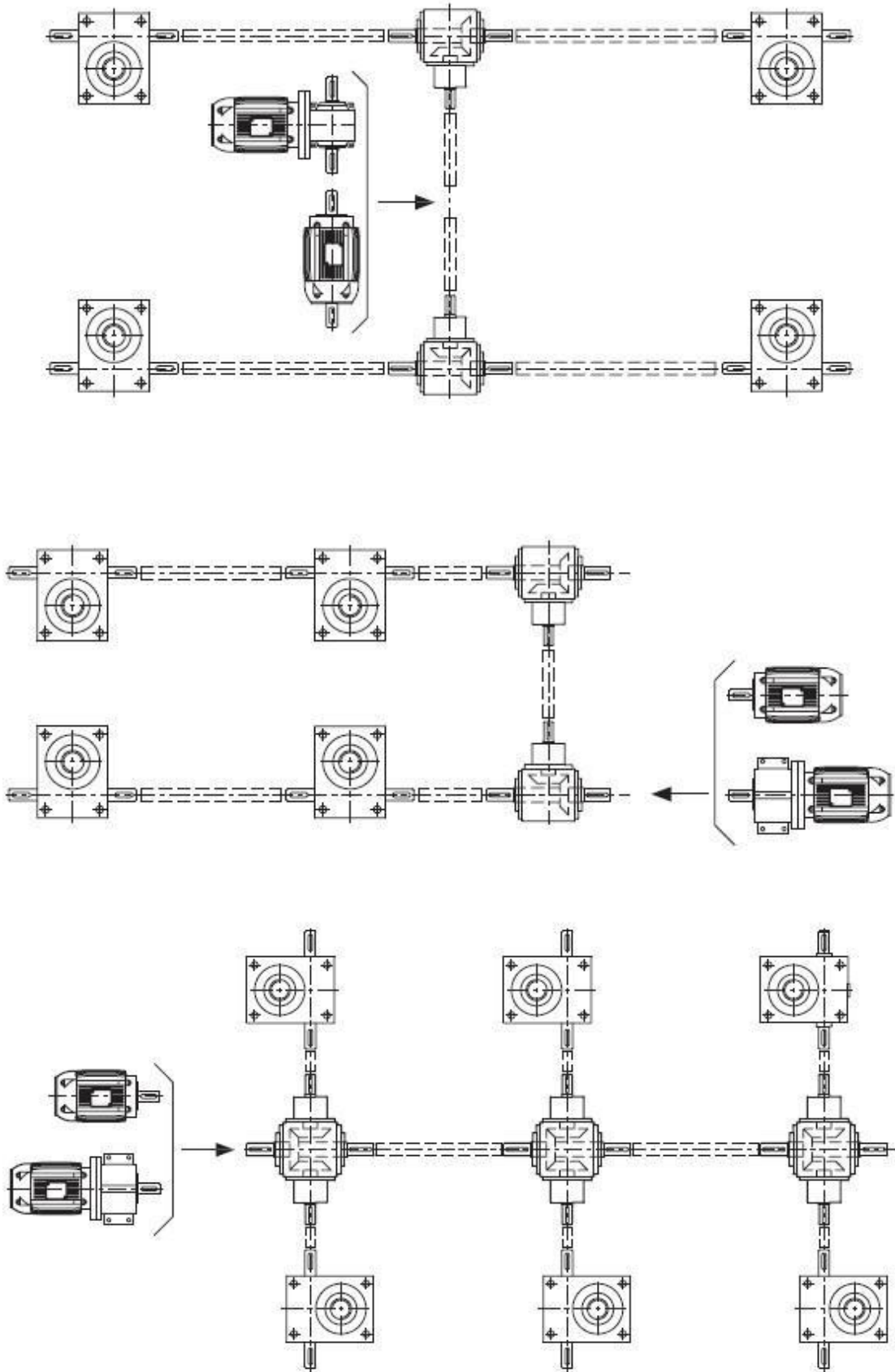

* RNS15 Translating Screw

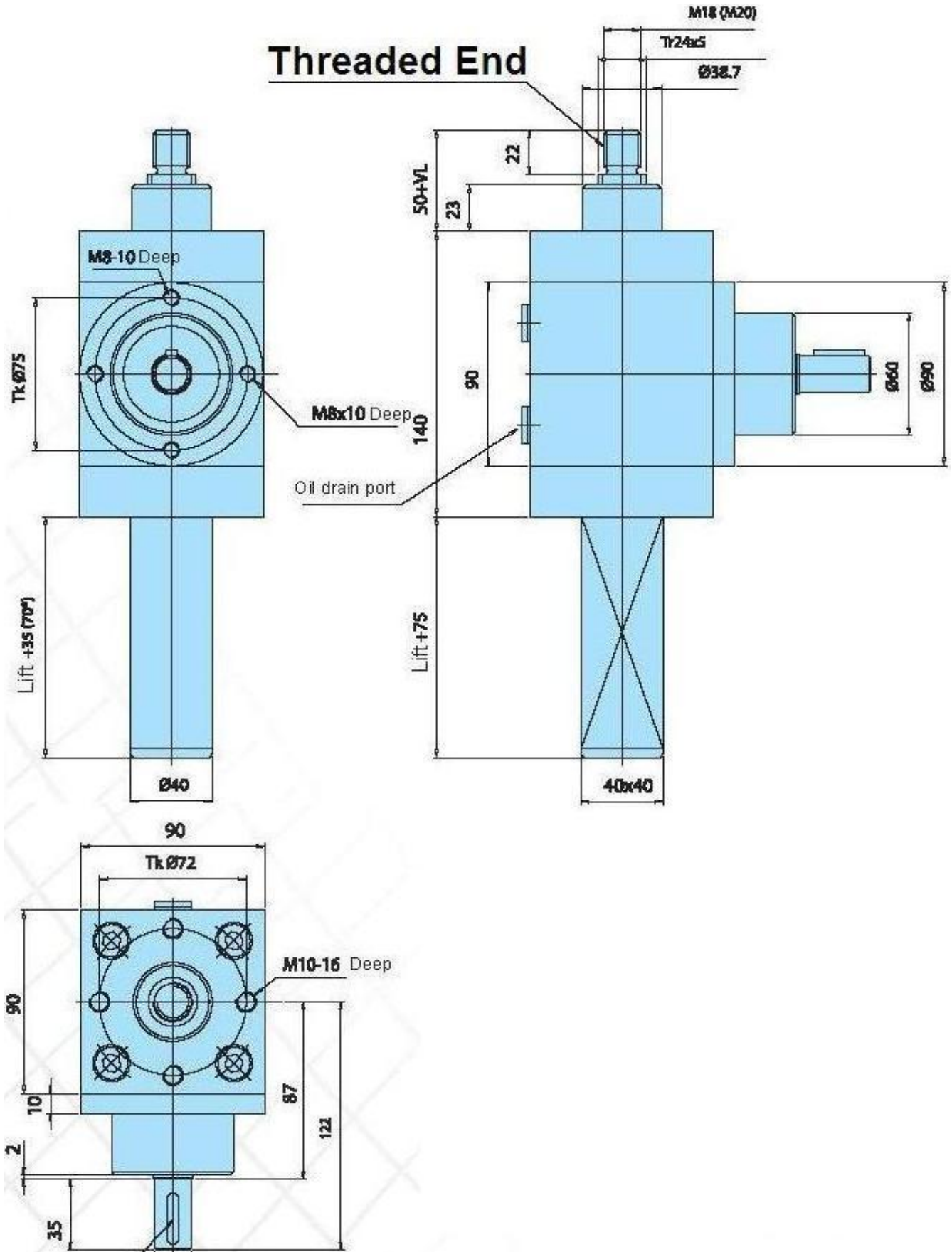

* RNS15 Rotating Screw

Plain End

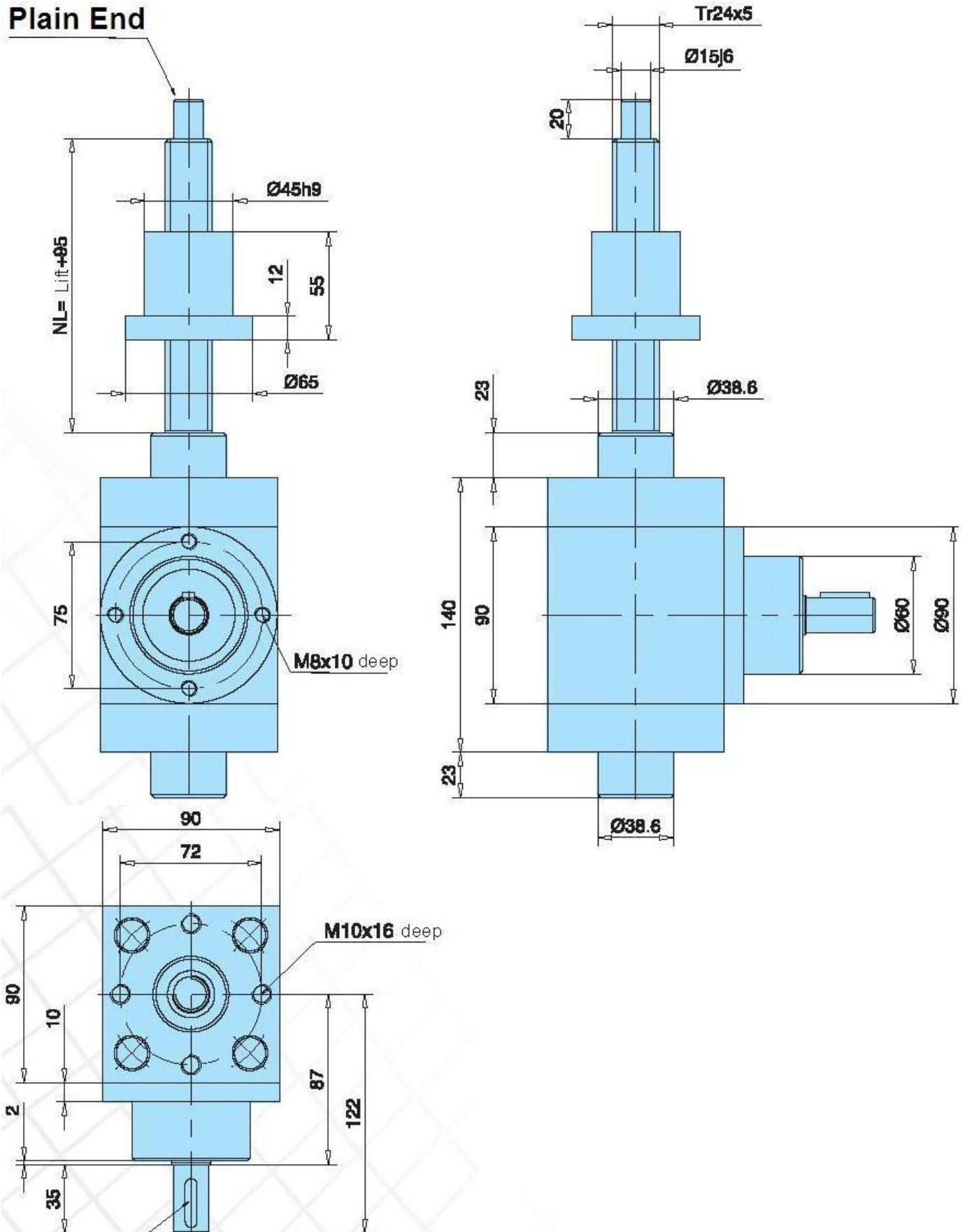

*** RNS25 Translating Screw**

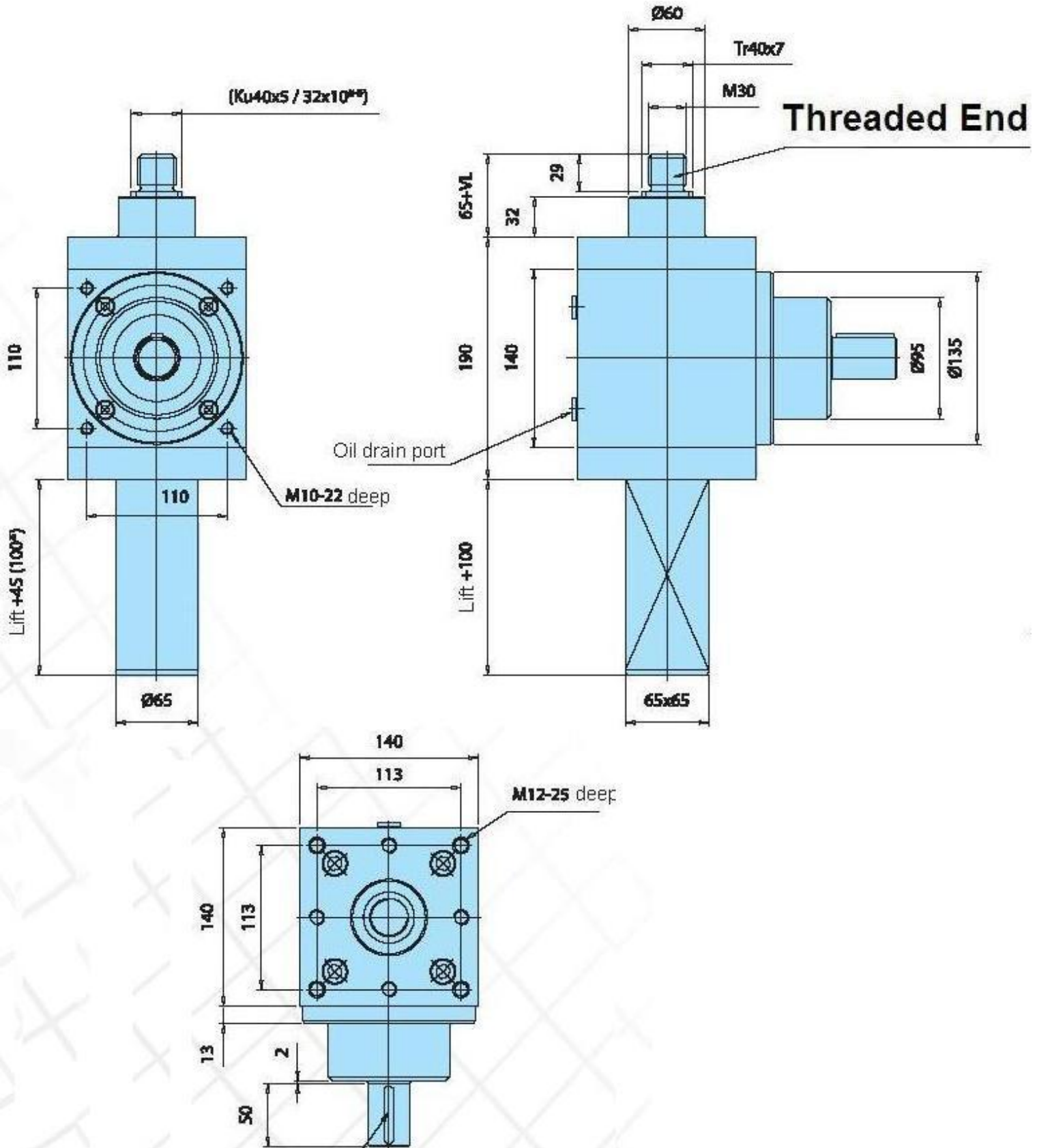

* RNS25 Rotating Screw

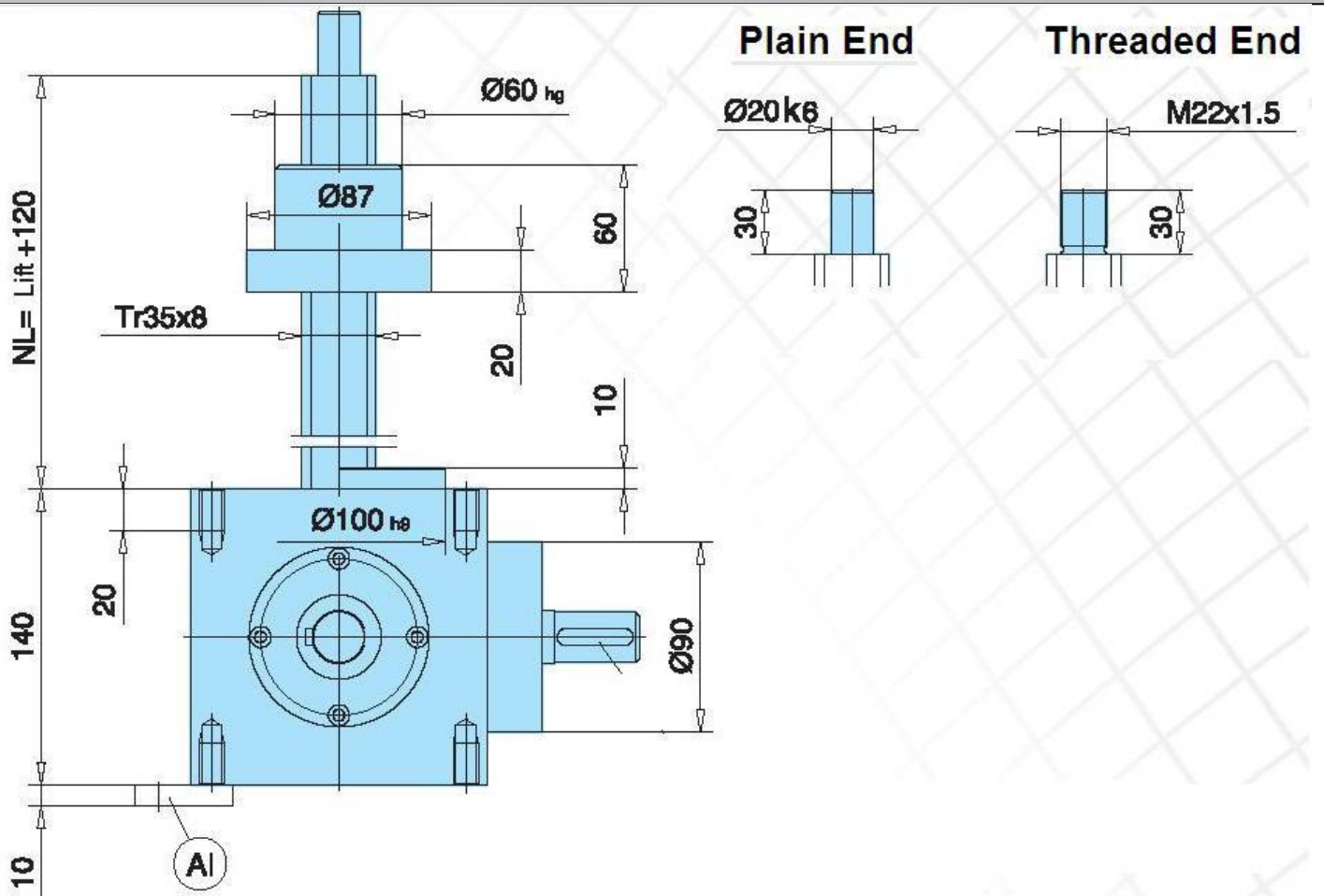

Mounting Brackets

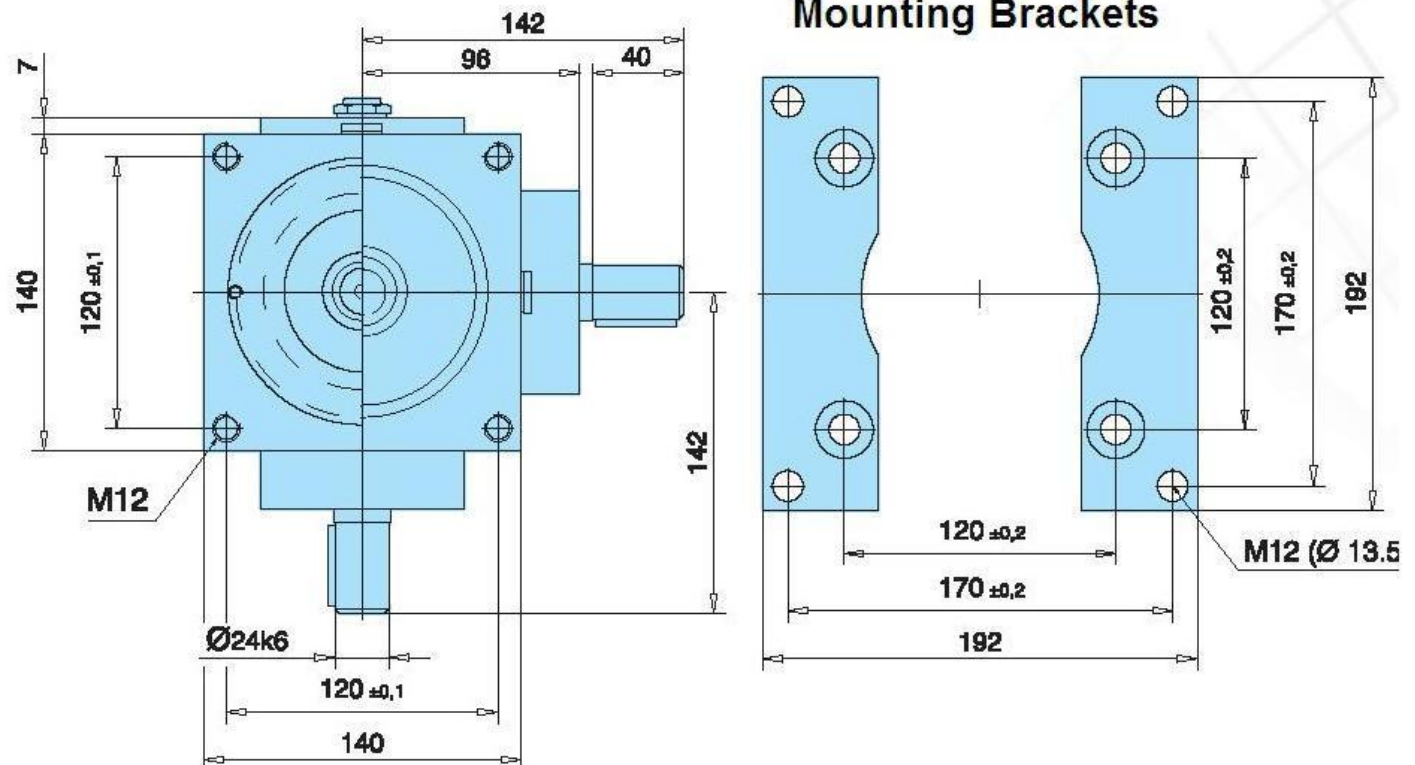

* RNS50 Translating Screw

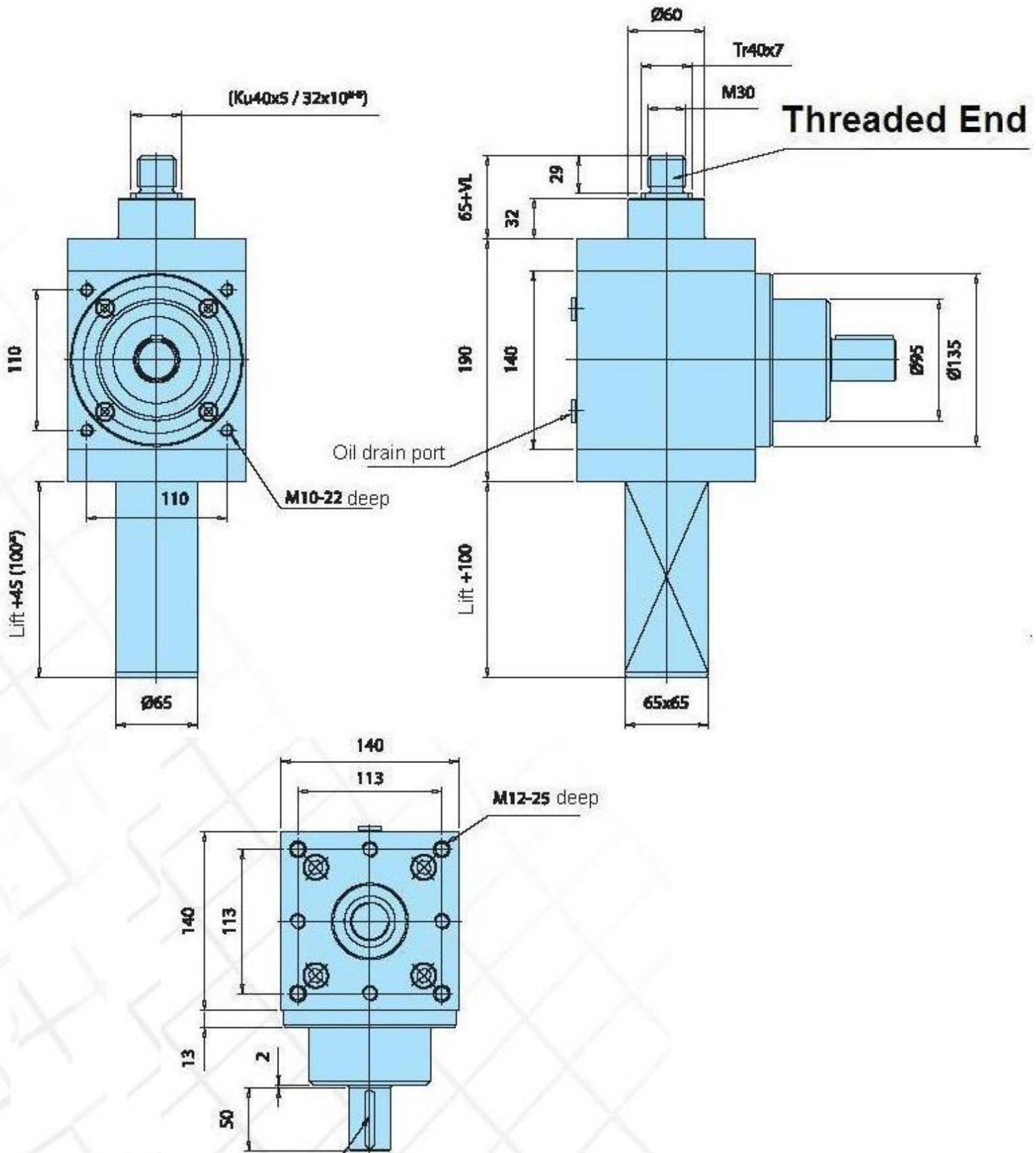

* RNS50 Rotating Screw

Plain End

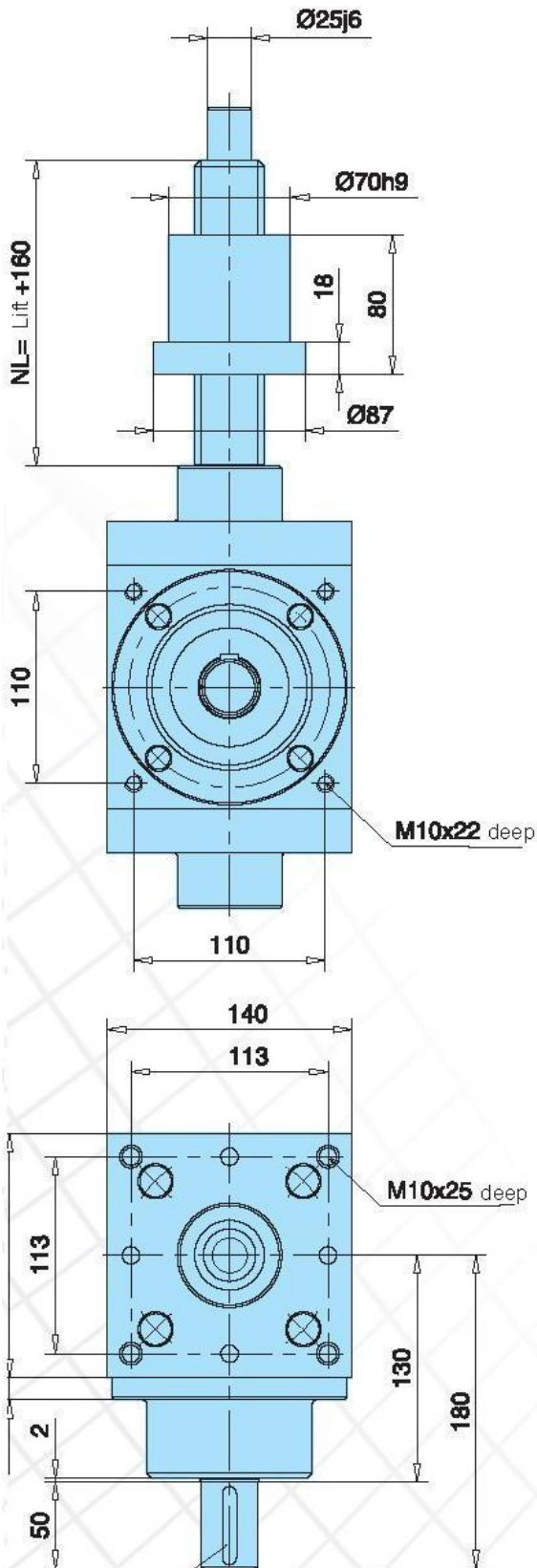

Threaded End

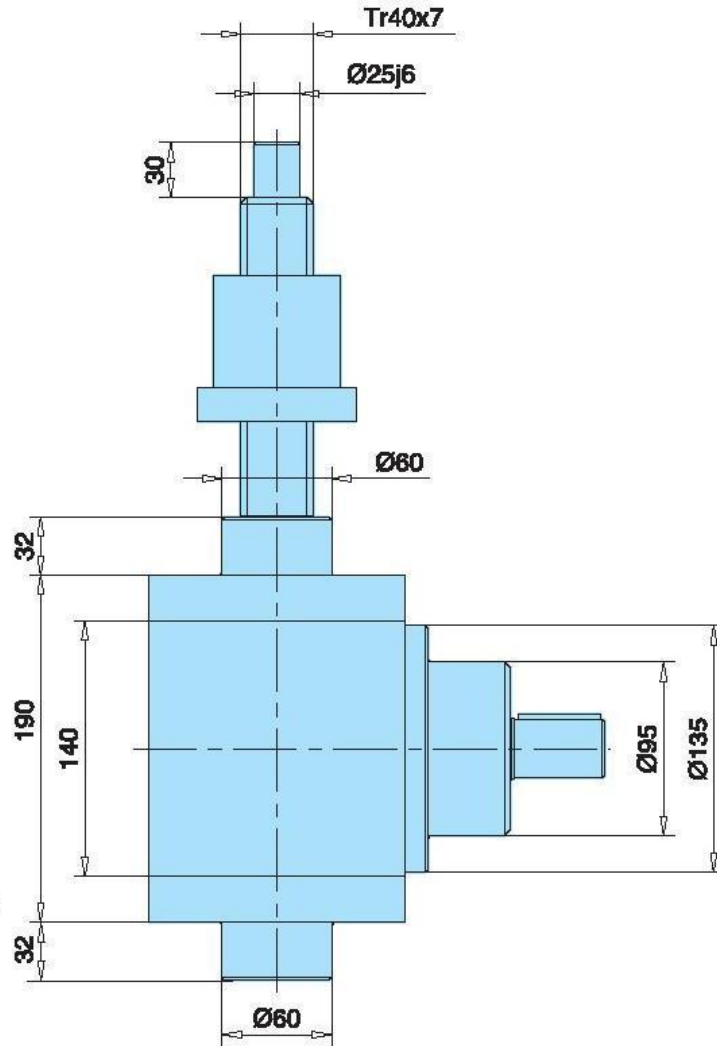

* RNS90 Translating Screw

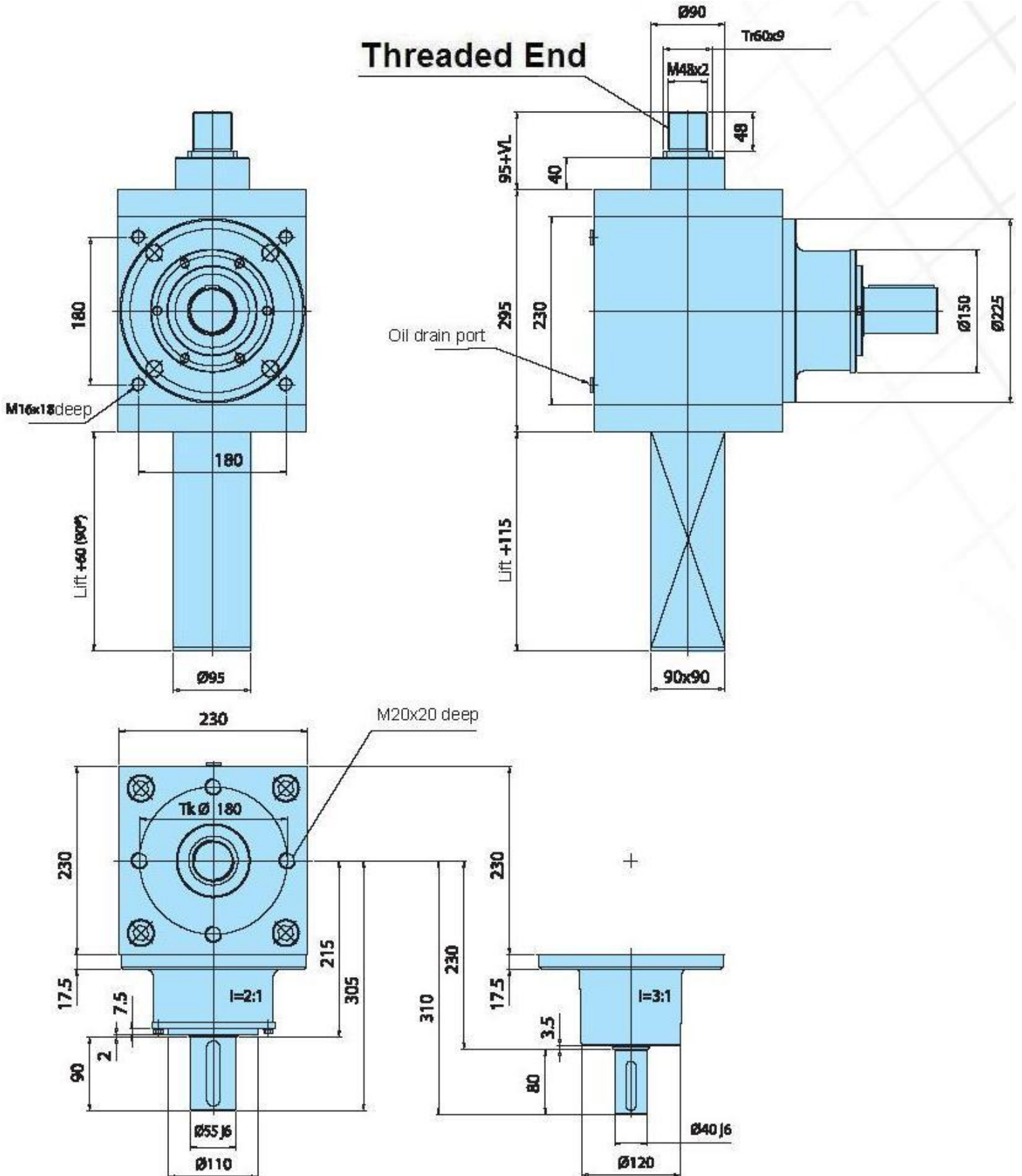

* RNS90 Rotating Screw

